

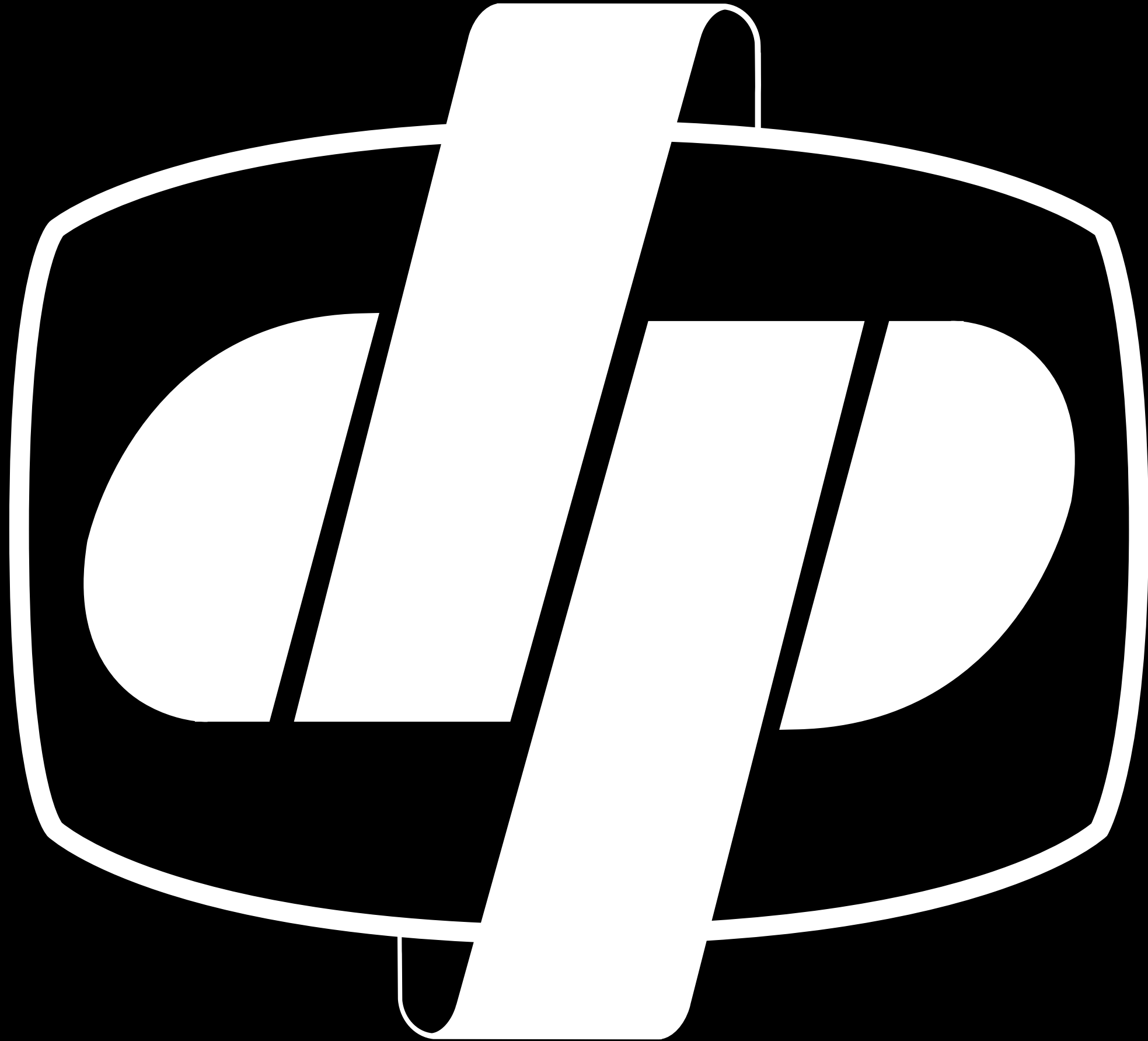



MADE IN USA | SINCE 1972





Manufacturers of "The Original Monster Stacks." Since 1972, Dynaflex Products has focused on innovative, performance oriented designs that set the standard for quality & functionality. We are proud to bring the heavy duty truck industry it's first line of air intake performance products. Made to run hard or to show off, these chrome plated air intake kits continue to "keep it simple" with one part number that provides complete bills of materials for specific make, model, and engine applications.

**3**

## **TECH GUIDE**

*CHROME AIR INTAKE KITS*

**5**

## **KENWORTH**

*2011-2017 W900L (5) 2018+ W900L (7)*

**9**

## **PETERBILT**

*1988-2006 379 (9) 2011-2017 389 (11) 2018+ 389 (13)*

**15**

## **TECH GUIDE**

*PATENTED AK LITE CHROME EXHAUST KITS*

## LOOK FOR DP

Consistency you can count on. We've been supplying chrome plated exhaust parts for 45+ years. To complete this project, engineering drew more than just insight from all that time to bring you these intake systems. You'll notice that some of the parts on the side of your truck mounting our exhaust might be under your hood now, too!

## CHROME IS WHERE THE HEART IS

Polished aluminum is cool and so is polished stainless, but nothing compares to chrome plated materials. Whether aluminum, stainless steel or anything else, you'll find it plated to perfection in these brand new air intake kits.

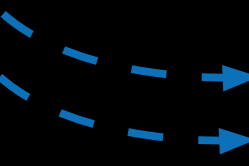

## UNDERCOVER KITS

If trying to take your engine to the next level, start with the only air intake kits for heavy duty trucks. Chrome plated pipework, branded silicone products and cleaner clamping technology make these new underhood kits the quickest and shiniest option for replacing ugly factory intake pipes.



## CUSTOM COBRA HEAD

One of the more custom upgrades featured in all the air intake kits are the gloss black "cobra heads" that mounts from your intake elbow to the backside of the turbo. Factory trucks run a ribbed, matte black rubber elbow that would look out of place next to all the new gloss black boots.

## GETTING HEATED

On the hot side of the system we feature nomex reinforced silicone boots that are good to 500°F to avoid any blow outs and down time. Factory versions are orange, you'll notice we color matched the outside gloss black while keeping the thermal protection on the interior.



# KENWORTH | W900L

MADE IN USA | SINCE 1972

**KIT APPLICATION**

ENGINE MAKE CUMMINS

ENGINE MODEL ISX

ENGINE YEARS 2011-2017

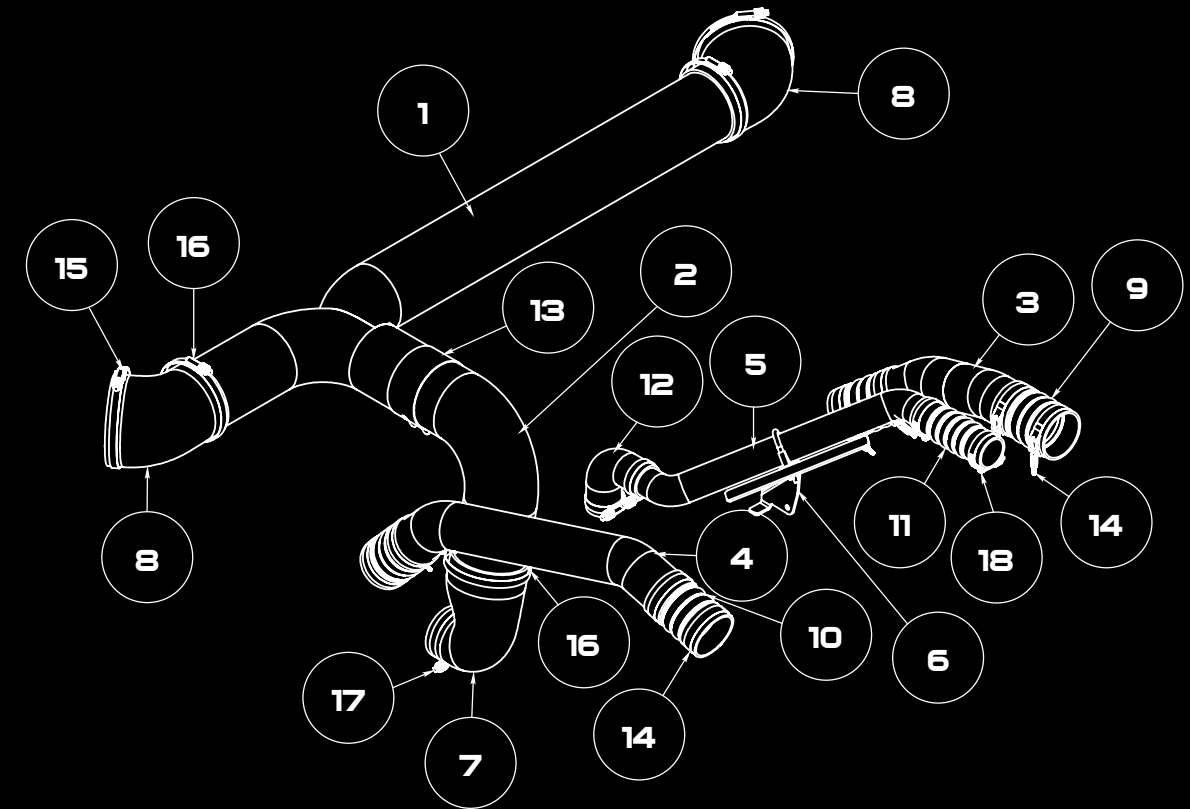

DYNAFLEX  PRODUCTS

**BILL OF MATERIALS**

ITEM	PART NUMBER	DESCRIPTION	QTY.
1	AT-ACP-KW	KW   AIRTUBE Y-PIPE   CHROME	1
2	AT-CPX-975X1275	AIRTUBE ELBOW   CHROME	1
3	14PAC-2178CP	CHARGE AIR COOLER PIPE   COLD SIDE   CHROME	1
4	14PAC-2177CP	CHARGE AIR COOLER PIPE   HOT SIDE   CHROME	1
5	14PAC-2437SCP	UPPER RADIATOR PIPE   SS CHROME	1
6	100PAC-2437	UPPER RADIATOR   BRACKET	1
7	272-44/36/-3070	TURBO INLET HOSE   CUSTOM COBRA HEAD	1
8	274-48/44-3030	AIR INTAKE Y-PIPE   SILICONE HOSE	2
9	203-36-2042	CHARGE AIR COOLER SILICONE HOSE   REINFORCED COLD SIDE	2
10	202-36-2042	CHARGE AIR COOLER SILICONE HOSE   REINFORCED HOT SIDE	2
11	270-23-2074	UPPER RADIATOR SILICONE HOSE   REINFORCED STRAIGHT	1
12	272-23-3030	UPPER RADIATOR SILICONE HOSE   ELBOW	1
13	50BJ-600SCP	50 SERIES   BRACKETLESS BJ CLAMP   SS CHROME	1
14	217-450-1	LIGHT DUTY SPRING CLAMP   CHARGE AIR COOLER	8
15	219-0800-1	Y-PIPE CONSTANT TORQUE CLAMPS	2
16	219-0700-1	CUSTOM COBRA HEAD CONSTANT TORQUE CLAMP   TOP	3
17	219-0450-1	CUSTOM COBRA HEAD CONSTANT TORQUE CLAMP   BOTTOM	1
18	219-0300-1	UPPER RADIATOR PIPE CONSTANT TORQUE CLAMPS	4

**KIT PART NUMBER**

**AIK-KWW-ISX**

# KENWORTH | W900L

MADE IN USA | SINCE 1972

**KIT APPLICATION**

ENGINE MAKE CUMMINS

ENGINE MODEL X15

ENGINE YEARS 2018+

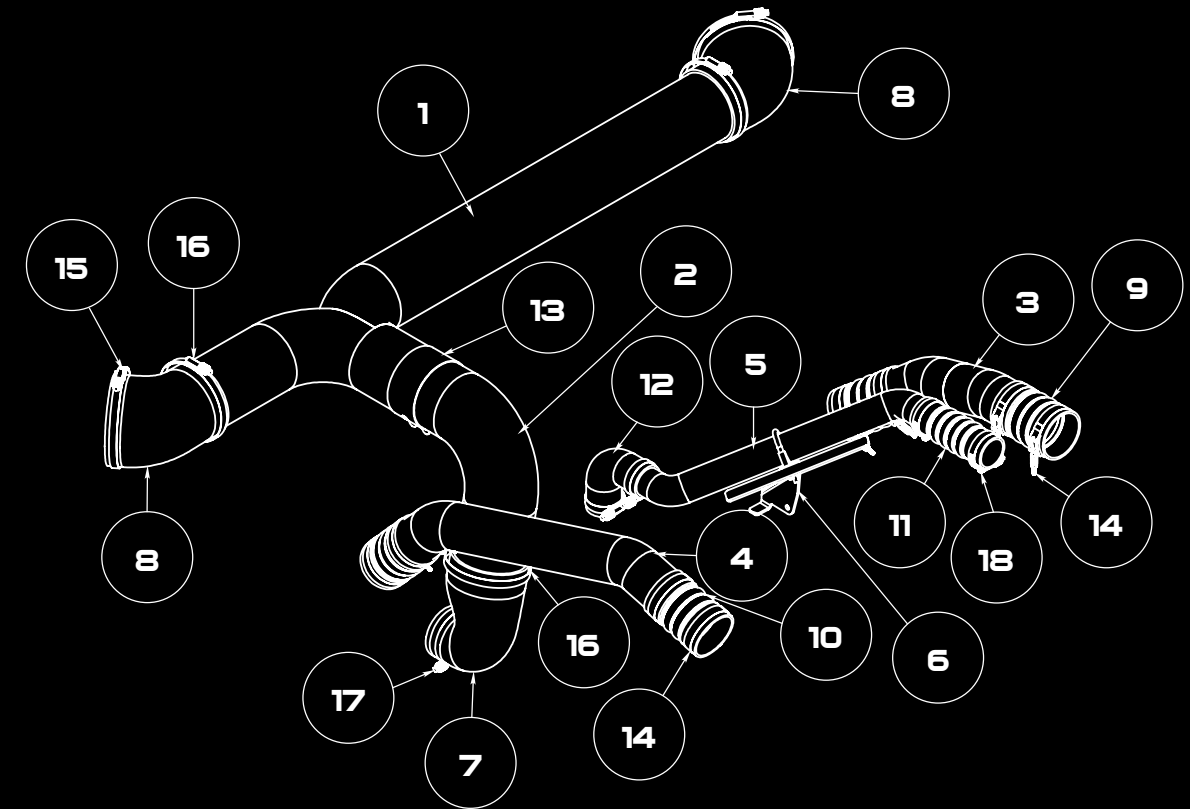

DYNAFLEX  PRODUCTS

**KIT PART NUMBER**

**AIK-KWW18-X15**

**BILL OF MATERIALS**

ITEM	PART NUMBER	DESCRIPTION	QTY.
1	AT-ACP-KW	KW   AIRTUBE Y-PIPE   CHROME	1
2	AT-CPX-975X1275	AIRTUBE ELBOW   CHROME	1
3	14PAC-2178CP	CHARGE AIR COOLER PIPE   COLD SIDE   CHROME	1
4	14PAC-2177CP	CHARGE AIR COOLER PIPE   HOT SIDE   CHROME	1
5	14PAC-2437SCP	UPPER RADIATOR PIPE   SS CHROME	1
6	100PAC-2437	UPPER RADIATOR   BRACKET	1
7	272-44/36/-3070	TURBO INLET HOSE   CUSTOM COBRA HEAD	1
8	274-48/44-3030	AIR INTAKE Y-PIPE   SILICONE HOSE	2
9	203-36-2042	CHARGE AIR COOLER SILICONE HOSE   REINFORCED COLD SIDE	2
10	202-36-2042	CHARGE AIR COOLER SILICONE HOSE   REINFORCED HOT SIDE	2
11	270-23-2074	UPPER RADIATOR SILICONE HOSE   REINFORCED STRAIGHT	1
12	272-23-3030	UPPER RADIATOR SILICONE HOSE   ELBOW	1
13	50BJ-600SCP	50 SERIES   BRACKETLESS BJ CLAMP   SS CHROME	1
14	217-450-1	LIGHT DUTY SPRING CLAMP   CHARGE AIR COOLER	8
15	219-0800-1	Y-PIPE CONSTANT TORQUE CLAMPS	2
16	219-0700-1	CUSTOM COBRA HEAD CONSTANT TORQUE CLAMP   TOP	3
17	219-0450-1	CUSTOM COBRA HEAD CONSTANT TORQUE CLAMP   BOTTOM	1
18	219-0300-1	UPPER RADIATOR PIPE CONSTANT TORQUE CLAMPS	4

KIT APPLICATION

ENGINE MAKE	CAT
ENGINE MODEL	C15
ENGINE YEARS	1988-2006

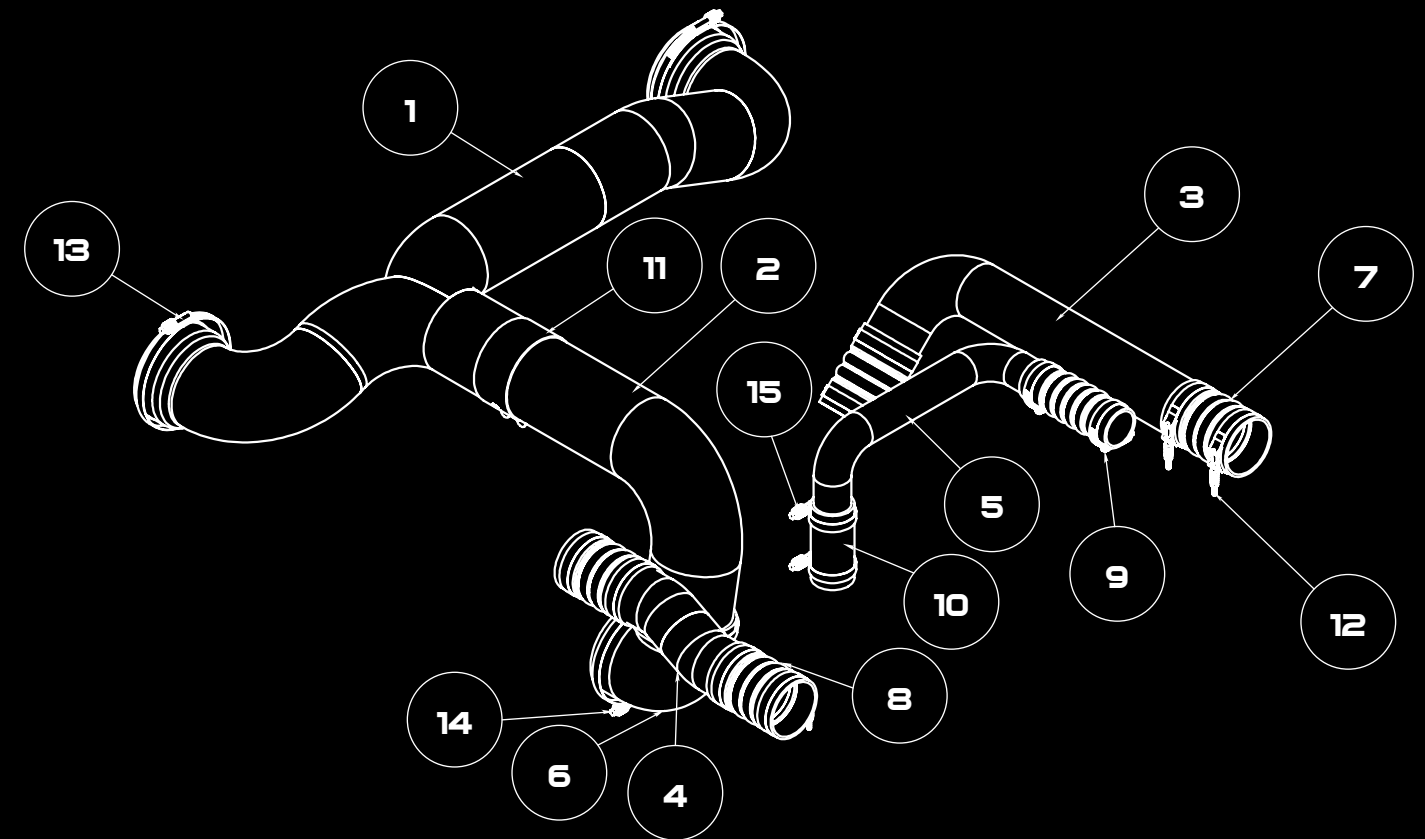

DYNAFLEX  PRODUCTS

KIT PART NUMBER

**AIK-379-C15**

BILL OF MATERIALS

ITEM	PART NUMBER	DESCRIPTION	QTY.
1	AT-CP-STRPB	PB   AIRTUBE Y-PIPE   STRAIGHT   CHROME	1
2	AT-CPX-1725X12	AIRTUBE ELBOW   CHROME	1
3	14PAC-379-CAC1RCP	CHARGE AIR COOLER PIPE   COLD SIDE	1
4	14PAC-379-CAC1LCP	CHARGE AIR COOLER PIPE   HOT SIDE	1
5	14PAC-379-UR1SCP	UPPER RADIATOR PIPE   SS CHROME	1
6	272-44-3030	TURBO INLET HOSE   CUSTOM COBRA HEAD	1
7	203-36-2042	CHARGE AIR COOLER SILICONE HOSE   REINFORCED COLD SIDE	2
8	202-36-2042	CHARGE AIR COOLER SILICONE HOSE   REINFORCED HOT SIDE	2
9	270-23-2074	UPPER RADIATOR SILICONE HOSE   REINFORCED STRAIGHT	1
10	271-23-3040	UPPER RADIATOR SILICONE HOSE   STRAIGHT	1
11	50BJ-600SCP	50 SERIES   BRACKETLESS BJ CLAMP   SS CHROME	1
12	217-450-1	LIGHT DUTY SPRING CLAMP   CHARGE AIR COOLER	8
13	219-0800-1	Y-PIPE CONSTANT TORQUE CLAMPS	2
14	219-0700-1	CUSTOM COBRA HEAD CONSTANT TORQUE CLAMP	2
15	219-0300-1	UPPER RADIATOR PIPE CONSTANT TORQUE CLAMPS	4



# PETERBILT | 389

MADE IN USA | SINCE 1972

**KIT APPLICATION**

ENGINE MAKE CUMMINS

ENGINE MODEL ISX

ENGINE YEARS 2011-2017

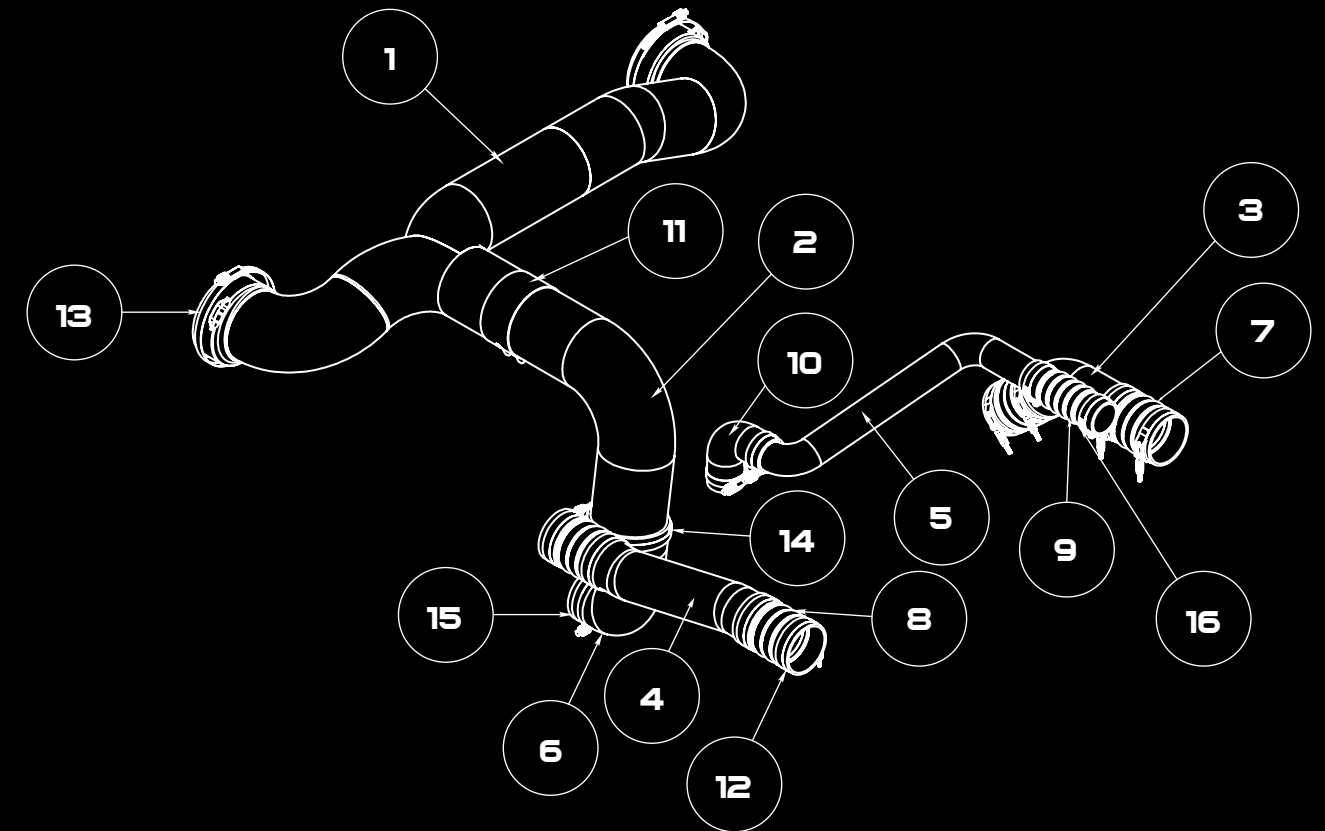

DYNAFLEX  PRODUCTS

**KIT PART NUMBER**

**AIK-389-ISX**

**BILL OF MATERIALS**

ITEM	PART NUMBER	DESCRIPTION	QTY.
1	AT-ACP-PB	PB   AIRTUBE Y- PIPE   CHROME	1
2	AT-ACPX-135X14	AIRTUBE ELBOW   CHROME	1
3	14PAC-6858CP	CHARGE AIR COOLER PIPE   COLD SIDE	1
4	14PAC-6841CP	CHARGE AIR COOLER PIPE   HOT SIDE	1
5	14PAC-6762SCP	UPPER RADIATOR PIPE   SS CHROME	1
6	272-44/36-3070	TURBO INLET HOSE   CUSTOM COBRA HEAD	1
7	203-36-2042	CHARGE AIR COOLER SILICONE HOSE   REINFORCED COLD SIDE	2
8	202-36-2042	CHARGE AIR COOLER SILICONE HOSE   REINFORCED HOT SIDE	2
9	270-23-2074	UPPER RADIATOR SILICONE HOSE   REINFORCED STRAIGHT	1
10	272-23-3030	UPPER RADIATOR SILICONE HOSE   ELBOW	1
11	50BJ-600SCP	50 SERIES   BRACKETLESS BJ CLAMP   SS CHROME	1
12	217-450-1	LIGHT DUTY SPRING CLAMP   CHARGE AIR COOLER	8
13	219-0800-1	Y-PIPE CONSTANT TORQUE CLAMPS	2
14	219-0700-1	CUSTOM COBRA HEAD CONSTANT TORQUE CLAMP   TOP	1
15	219-0450-1	CUSTOM COBRA HEAD CONSTANT TORQUE CLAMP   BOTTOM	1
16	219-0300-1	UPPER RADIATOR PIPE CONSTANT TORQUE CLAMPS	4



# PETERBILT | 389

MADE IN USA | SINCE 1972

**KIT APPLICATION**

ENGINE MAKE CUMMINS

ENGINE MODEL X15

ENGINE YEARS 2018+

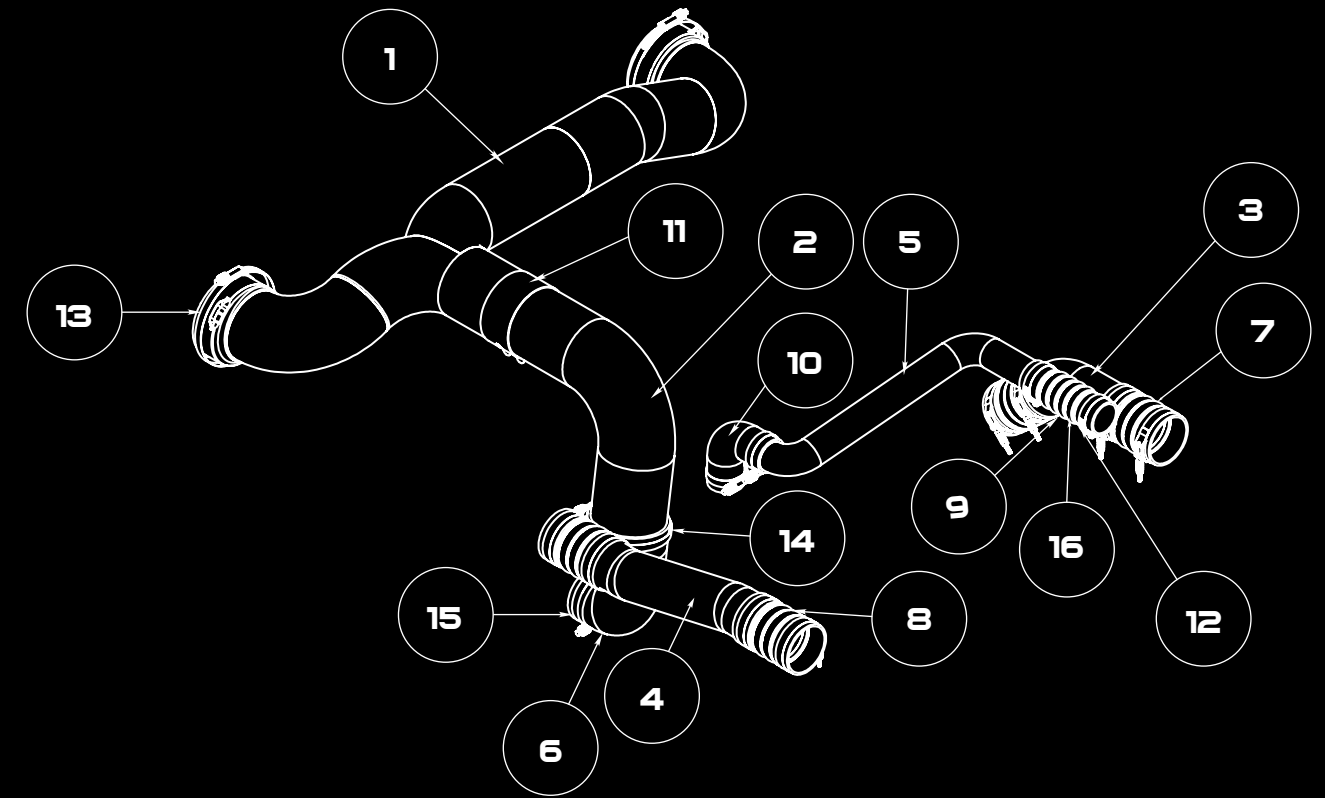

DYNAFLEX  PRODUCTS

**KIT PART NUMBER**

**AIK-389-X15**

**BILL OF MATERIALS**

ITEM	PART NUMBER	DESCRIPTION	QTY.
1	AT-ACP-PB	PB   AIRTUBE Y- PIPE   CHROME	1
2	AT-ACPX-155X155	AIRTUBE ELBOW   CHROME	1
3	14PAC-6858CP	CHARGE AIR COOLER PIPE   COLD SIDE   CHROME	1
4	14PAC-2674CP	CHARGE AIR COOLER PIPE   HOT SIDE   CHROME	1
5	14PAC-6762SCP	UPPER RADIATOR PIPE   SS CHROME	1
6	272-44/36-3070	TURBO INLET HOSE   CUSTOM COBRA HEAD	1
7	203-36-2042	CHARGE AIR COOLER SILICONE HOSE   REINFORCED COLD SIDE	2
8	202-36-2042	CHARGE AIR COOLER SILICONE HOSE   REINFORCED HOT SIDE	2
9	270-23-2074	UPPER RADIATOR SILICONE HOSE   REINFORCED STRAIGHT	1
10	272-23-3030	UPPER RADIATOR SILICONE HOSE   ELBOW	1
11	50BJ-600SCP	50 SERIES   BRACKETLESS BJ CLAMP   SS CHROME	1
12	217-450-1	LIGHT DUTY SPRING CLAMP   CHARGE AIR COOLER	8
13	219-0800-1	Y-PIPE CONSTANT TORQUE CLAMPS	2
14	219-0700-1	CUSTOM COBRA HEAD CONSTANT TORQUE CLAMP   TOP	1
15	219-0450-1	CUSTOM COBRA HEAD CONSTANT TORQUE CLAMP   BOTTOM	1
16	219-0300-1	UPPER RADIATOR PIPE CONSTANT TORQUE CLAMPS	4





# HEAT SHIELDS ARE GETTING KOOLER

PATENTED  
AK LITE TECHNOLOGY

AVAILABLE FOR  
KW W900L | 2007-2021+

SMOOTH DYNAFLEX MADE  
REPLACEMENT BOX COVERS

MADE IN USA | SINCE 1972

## DYNAFLEX PRODUCTS

The patented Air Kooled Lite Series (AK) combines more than 45 years of experience constructing the highest quality exhaust systems for trucks. Utilizing modern processes and materials, we are proud to bring you the most technologically advanced truck exhaust product offering, ever. Combining our patented technology with a dedication to no drilling, no fabricating - bolt on Kits - we are excited to release some long overdue aftermarket options for trucks with exhaust temperature profiles outside of the acceptable range for any standard plated product or gimmicky coating.

# AK LITE

BY THE MAKERS OF THE ORIGINAL MONSTER STACKS





MADE IN USA | SINCE 1972

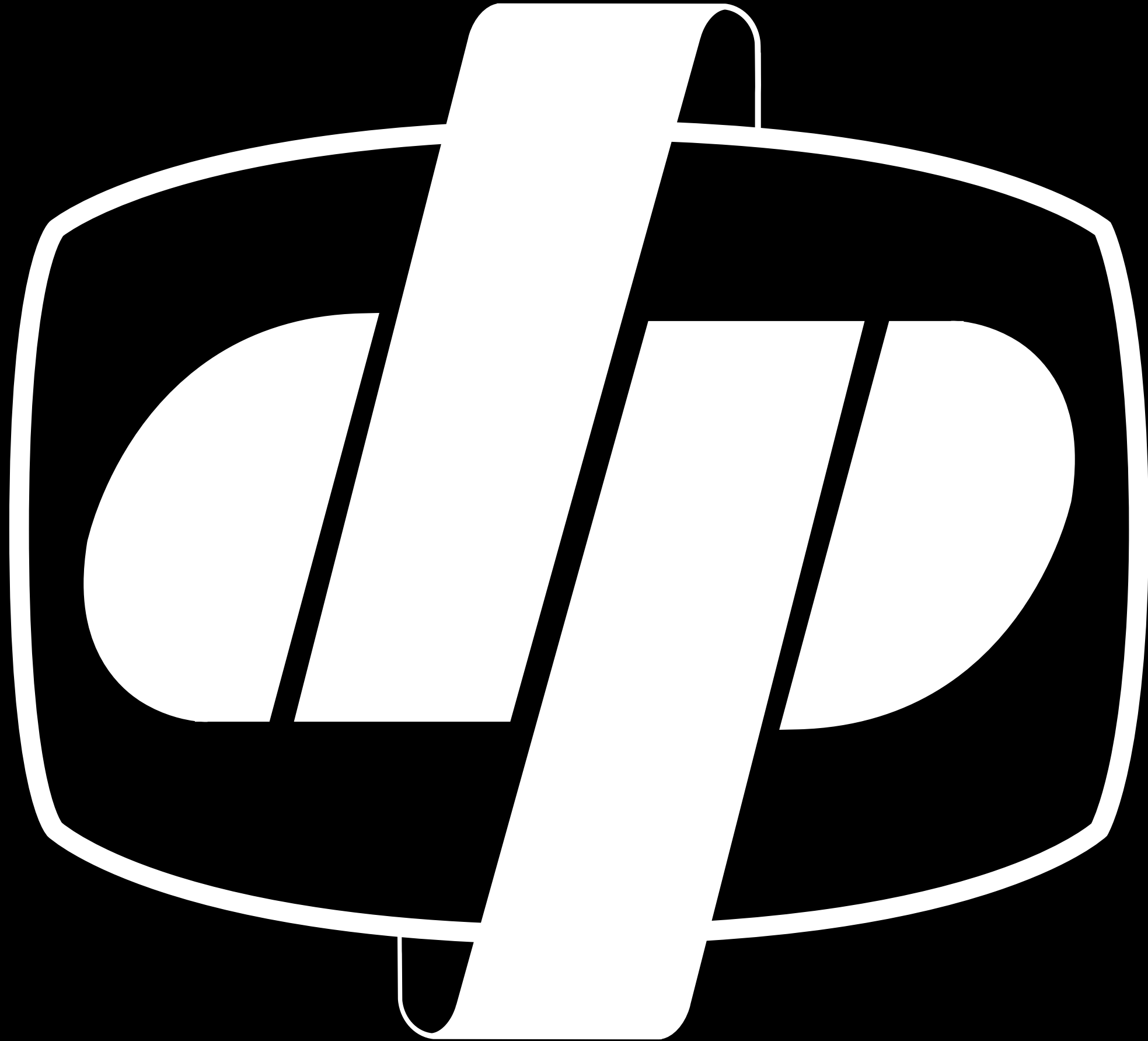

**MADE IN  
USA**

**SINCE  
1972**



**CALIFORNIA, MANUFACTURING  
AND WAREHOUSE  
6466 GAYHART STREET  
COMMERCE, CA 90040**

**f /DYNAFLEXUSA**

**#LIVETHESHOW**

**📷 @DYNAFLEX\_USA**